

MITER SAW STAND
SCHEMATIC

MODEL NO. UU 240F

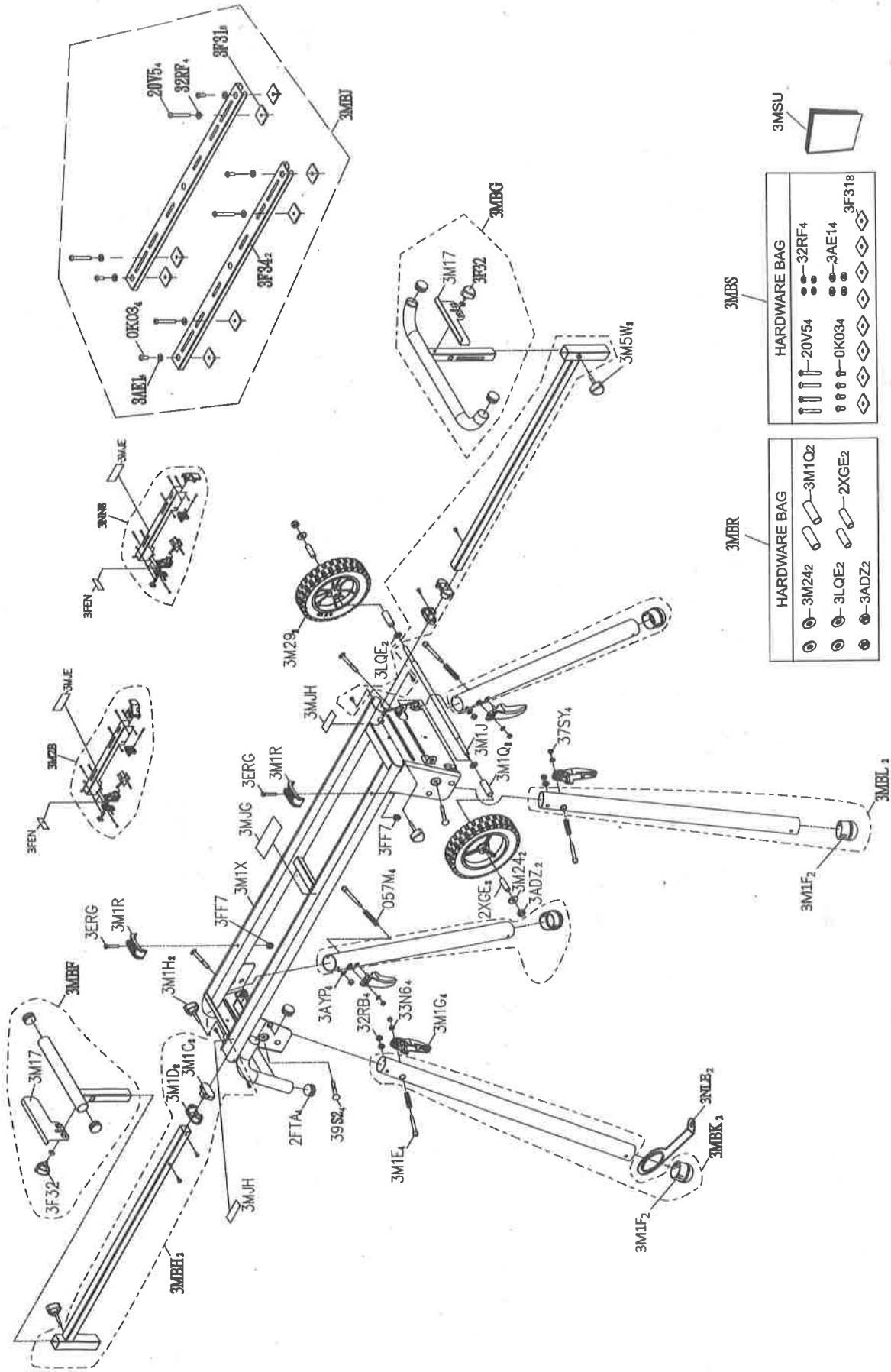

3MSU															
3MBS	<table border="1"> <tr> <th colspan="2">HARDWARE BAG</th> </tr> <tr> <td></td> <td>20V54</td> </tr> <tr> <td></td> <td>32RF4</td> </tr> <tr> <td></td> <td>3AE14</td> </tr> <tr> <td></td> <td>0K034</td> </tr> <tr> <td></td> <td>3F318</td> </tr> </table>	HARDWARE BAG			20V54		32RF4		3AE14		0K034		3F318		
HARDWARE BAG															
	20V54														
	32RF4														
	3AE14														
	0K034														
	3F318														
3MBR	<table border="1"> <tr> <th colspan="2">HARDWARE BAG</th> </tr> <tr> <td></td> <td>3M1Q2</td> </tr> <tr> <td></td> <td>2XGE2</td> </tr> <tr> <td></td> <td>3ADZ2</td> </tr> <tr> <td></td> <td>3M242</td> </tr> <tr> <td></td> <td>3LQE2</td> </tr> <tr> <td></td> <td>3ADZ2</td> </tr> </table>	HARDWARE BAG			3M1Q2		2XGE2		3ADZ2		3M242		3LQE2		3ADZ2
HARDWARE BAG															
	3M1Q2														
	2XGE2														
	3ADZ2														
	3M242														
	3LQE2														
	3ADZ2														

PARTS LIST

MITER SAW STAND
PARTS LIST

MODEL NO. UU 240F

Always order by I.D. NO. number

HKU NO.	I.D. NO.	Description	Size	Q'ty
339787	057M	SPRING		4
370335	0K03	HEX. SOC. TRUSS HD. SCREW	M8*1.25-15	4
339788	20V5	HEX. SOC. TRUSS HD. SCREW	M8*1.25-60	4
339789	2FTA	END CAP		4
339790	2XGE	SLEEVE		2
339791	32RB	LOCK NUT	M8*1.25 T=8	4
339792	32RF	FLAT WASHER	φ8*18-2	4
339793	33N6	FLAT WASHER	φ6*13-1.5	4
339794	37SY	LOCK NUT	M6*1.0 T=6	4
339795	39S2	CAP HD. SQ. NECK BOLT	M8*1.25-65	4
339796	3ADZ	LOCK NUT	M10*1.5 T=10	2
339797	3AE1	FLAT WASHER	φ8*28-2.5	4
339798	3AYP	FLAT WASHER	φ8.1*16-2	4
339800	3ERG	HEX. HD. BOLT	M6*1.0-40	2
339801	3F31	SQUARE NUT		8
339802	3F32	KNOB		2
339803	3F34	RAIL		2
339804	3FF7	CROWN NUT	M6*1.0 T=13	2
339866	3FEN	CAUTION LABEL		2
339805	3LQE	FLAT WASHER	φ10*20-2	2
339806	3M17	FENCE		2
339807	3M1C	PLUG-BUTTON		2
339808	3M1D	PLUG-BUTTON		2
339809	3M1E	LOCATION PIN		4
370546	3M1F	PLUG-BUTTON		4
339810	3M1G	PLUNGER HANDLE		4
339811	3M1H	KNOB		2
339812	3M1J	LINK BAR		1
339813	3M1Q	SLEEVE		2
339814	3M1R	GUIDE CLAMP		2
339815	3M1X	TABLE ASS'Y		1
339816	3M24	FLAT WASHER	φ10*25-2	2
339817	3M29	FLOOR WHEEL ASS'Y		2
339818	3M2B	PARALLEL BRACKET ASS'Y		1
339819	3M5W	KNOB		2
339820	3MBF	EXTENSION ARM SUPPORT ASS'Y		1
339821	3MBG	EXTENSION ARM SUPPORT ASS'Y		1
339822	3MBH	EXTENSION ARM ASS'Y		2
339823	3MBJ	AUXILIARY MOUNTING BRACKET ASS'Y		1
339824	3MBK	STAND LEG ASS'Y		2
339825	3MBL	STAND LEG ASS'Y		2
339826	3MBR	WHEELS HARDWARE BAG		1
339827	3MBS	AUXILIARY MOUNTING BRACKET HARDWARE BAG		1
370029	3MJE	TRADEMARK LABEL		2
370030	3MJG	WARNING LABEL		1
370031	3MJH	WARNING LABEL		2
339828	3MSU	INSTRUCTION MANUAL		1
339829	3NLE	ANCHOR PLATE		2
339830	3NN8	PARALLEL BRACKET ASS'Y		1